

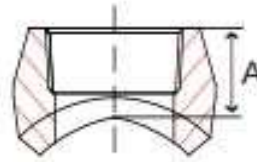

Threaded Outlet

Forged Carbon Steel, Class 3000

Inches / Pounds



Part #	ID Threaded Size- NPT	For Nominal Pipe Sizes	(A) Center Length	Approximate Weight Each
KTO.25-.375X36	1/4	3/8" thru 36"	0.75	0.02
KTO.5-.75X36	1/2	3/4" thru 36"	1.00	0.20
KTO.75-1X1.25	3/4	1" thru 1-1/4"	1.06	0.20
KTO.75-1.5X36	3/4	1-1/2" thru 36"	1.06	0.20
KTO1-1.25X2.5	1	1-1/4" thru 2-1/2"	1.31	0.50
KTO1-3X36	1	3" thru 36"	1.31	0.50
KTO1.25-1.5	1-1/4	1-1/2"	1.31	0.80
KTO1.25-2X3.5	1-1/4	2" thru 3-1/2"	1.31	0.80
KTO1.25-2.5X36	1-1/4	4" thru 36"	1.31	0.80
KTO1.5-2X2.5	1-1/2	2" thru 2-1/2"	1.38	1.00
KTO1.5-3X5	1-1/2	3" thru 5"	1.38	1.00
KTO1.5-6X36	1-1/2	6" thru 36"	1.38	1.70
KTO2-2.5X3.5	2	2-1/2" thru 3"	1.50	1.70
KTO2-4X6	2	4" thru 6"	1.50	1.70
KTO2-8X36	2	8" thru 36"	1.50	1.70
KTO2.5-3X3.5	2-1/2	3" thru 3-1/2"	1.50	2.50
KTO2.5-4X5	2-1/2	4" thru 5"	1.81	2.50
KTO2.5-6X8	2-1/2	6" thru 8"	1.81	2.50
KTO2.5-10X36	2-1/2	10" thru 36"	1.81	2.50
KTO3-3.5X4	3	3-1/2" thru 4"	2.00	4.00
KTO3-5X6	3	5" thru 6"	2.00	4.00
KTO3-8X14	3	8" thru 14"	2.00	4.00
KTO3-16X36	3	16" thru 36"	2.00	4.00
KTO4-5X6	4	5" thru 6"	2.25	6.30
KTO4-8X10	4	8" thru 10"	2.25	6.30
KTO4-12X20	4	12" thru 20"	2.25	6.30
KTO4-22X36	4	22" thru 36"	2.25	6.30

***Forged fitting material conforms to ASTM SA105N, NORMALIZED**

***NPT threads conform to ASME B1.20.1**

***Manufacturing facility is ISO 9001:2008 Certified**

***Dimensions conform to ASME B16.11**